



Installation Instruction

Mississauga, Ontario
Canada

DESCRIPTION: DOCUMENT 8580/90 RAM MOUNT INSTALLATION
INSTRUCTION SHEET

NOTE - FOR SUPPLIER/VENDOR:

- THIS DOCUMENT HAS A TOTAL OF 14 PAGES, INCLUDING COVER SHEET
- ALL PAGES, EXCLUDING COVER SHEET, ARE REQUIRED FOR CUSTOMER INSTRUCTION
- **DO NOT** INCLUDE FIRST PAGE IN ASSEMBLY PACKAGE

ITEM GROUP	A00DOC	APPROVALS			DATE	 Mississauga, Ontario	
PRODUCT TYPE	VN0	DRAWN BY:	KEN TAYLOR		DEC-07-06		
EDR/O STATUS		CHKD. BY:	DATE:	APPROV'D. BY:	TITLE: DOCUMENT 8580/90 RAM MOUNT INSTALLATION INSTRUCTION SHEET		
	OBSOLETE	PROD. / PROJ. ENG.:					
	ENGINEERING ONLY	MECH. ENG.:					
	PRE-PILOT	ELEC. ENG.:					
	BETA	OTHER:					
X	RELEASED	INSTALLATION INSTRUCTION FORM: U:\engdata\RELEASE\MISSISSAUGA PRODUCTS\DO Blank_Forms\installation instruction_portrait.doc			SIZE	DRAWING NO.	REV.
EDR/EDO NO.:	8715				A	1616307	B.1
					SHEET 1 OF 14		

Installation Instruction for MT34XX RAM Mounting Kit

WARNING: Failure to install the mount correctly or modifications to the mount may result in serious injury or damage to property. Contact Psion Teklogix Technical Support or your Psion Teklogix representative if you have problems installing this mount. To ensure operator safety, you must use a calibrated torque wrench and the supplied mounting hardware when fastening the cradle and mount. Use of this mount in vehicles driven on public roads or highways is prohibited. Contact Psion Teklogix for further details.

Before mounting an 8580/90 in a vehicle, there are a number of operator safety issues that require careful attention. An improperly mounted 8580/90 may result in one or more of the following: operator injury, property damage, operator visibility obstruction, operator distraction and/or poor ease of egress for the operator. Psion Teklogix strongly recommends that you seek professional mounting advice from the vehicle manufacturer.

When mounting an 8580/90 use only approved Psion Teklogix mounting hardware and mounting parts which are specific to the 8580/90 model purchased. Use of non-approved parts may result in one or more of the following: operator injury, property damage, operator visibility obstruction, operator distraction and/or poor ease of egress for the operator.

If it is necessary to mount the 8580/90 overhead or in any position that could cause injury to the operator should the unit fall, it is critical that a secondary tether or other failsafe device be installed.

The following restrictions must be strictly enforced:

- Do not use the mount and/or the 8580/90 as a hand-hold. Using the mount in this manner may cause the person to fall or dislodge the mounting hardware and/or mounts.
- Do not add weight or attach any other items to the mount or 8580/90. Additional elements may fall causing injury or may increase chance of failure and/or damage in mounting hardware and/or mounts.

Mounts used in industrial or vibration generating environments may be subjected to fatigue, stress and/or part wear. A periodic inspection of the mounting hardware and mounts should be performed to ensure parts are retightened to the correct torque, free of fractures, excessive wear and/or other environmental damage. Any parts found to be unsafe should be removed and replaced immediately. After inspection or replacement of parts readjust the mount as outlined in step 3 of section B below and tighten RAM Mounting arm with approved tightening tool (part number 9000594).

Installation Instructions for Standard Mounting Bracket

Section A

A1. Standard Mounting Bracket Preparation

This standard mount can be installed in an orientation from 15° to 30° from the vertical (See Figure 1 and 2). Select the best orientation for your specific application.

The mounting platform must be of sufficient strength to support 25 kg. Never attach this mount to a plastic dash or a wooden platform without the appropriate backing plate and bracing. When selecting a mounting location – make sure you provide the operator access to the top, bottom & sides.

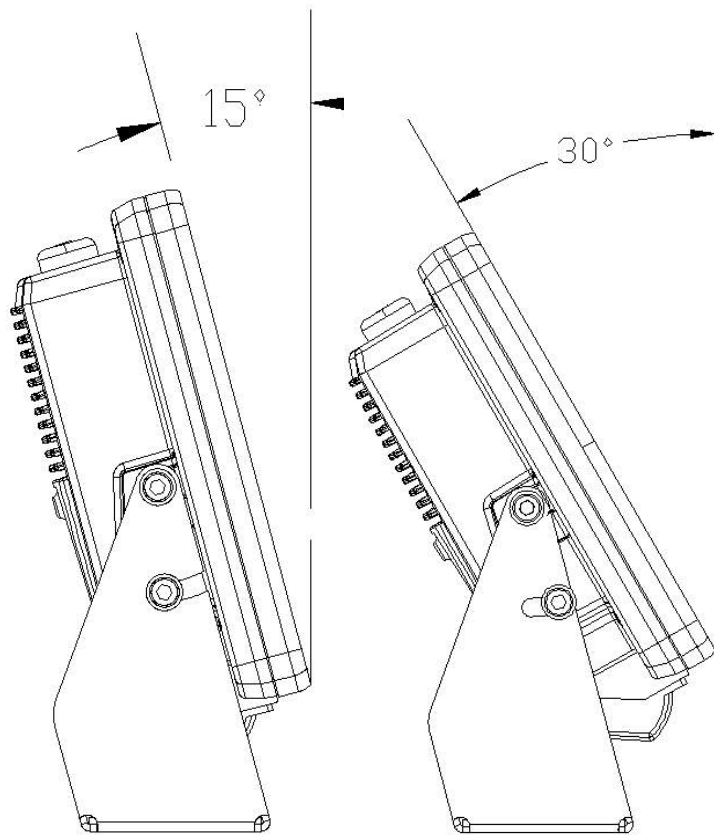

Figure 1

Figure 2

A2. Installation

Step 1: Secure Standard Mounting Bracket to Local Platform: Use the supplied bolt hole pattern to drill the required holes in the local platform. Hole diameters must not exceed 9mm [11/32 inches] for securing Standard Mounting Bracket (D) to the local platform. If replacement hardware is need, it should be consistent with these diameters. All fasteners must use a suitable locking mechanism to ensure they do not loosen under shock & vibration.

Step 2: Assemble Standard Mounting Bracket to 8580/90 VMT: For assembling the Standard Mounting Bracket (B) to the 8580/90 Terminal (A) see **Figure 3**.

Legend:	
A	8580/90 VMT
B	Screw M8 x 12 Hex Socket
C	Washer M8 Flat
D	Mount Standard Bracket

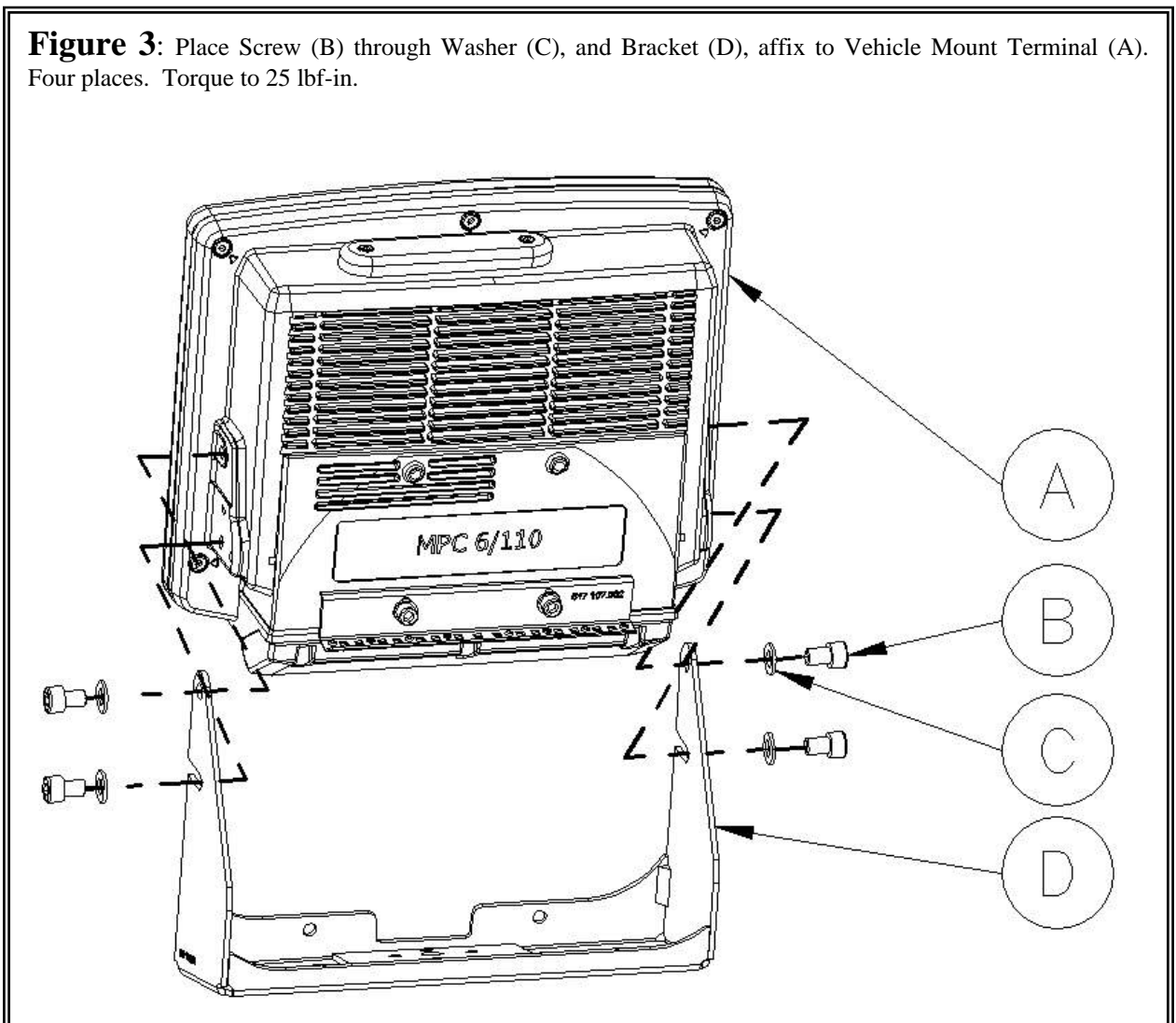

Installation Instructions for RAM Mount

Section B

BI. RAM Mount Preparation

This articulating mount can be installed in a wide variety of orientations (See Figure 9). Select the best orientation for your specific application. Preferred orientations maintain the centre of mass of the vehicle mount assembly directly over the centre of the base (See Figure 4).

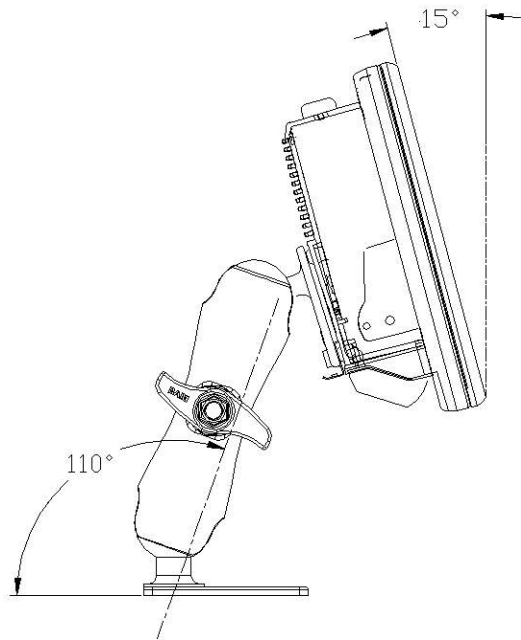

Figure 4

Note the tilt & rotation of the cradle can be easily adjusted by the operator. Ensure that if the handscrew is loosened and the cradle slips, the operator & any equipment cannot be damaged by it. Also note that under extreme vibration the mount may slowly 'settle', requiring readjustment and tightening of the handscrew. Psion Teklogix offers a tightening tool (part number 9000594) which can be used to minimize settling. (See Figure 5)



Figure 5

The mounting platform must be of sufficient strength to support 25 kg. Never attach this mount to a plastic dash or a wooden platform without the appropriate backing plate and bracing. When selecting a mounting location – make sure you provide the operator access to the top, bottom & sides.

B2. Installation

Step 1: Remove Cable Bracket from 8580/8590 VMT: Before installing RAM Vesa Base (E), **REMOVE** screws, washer and cable bracket from terminal. See **Figure 6**

Legend:	
A	8580/90 VMT
E	RAM Vesa Base (Smaller)
F	Washer M6 Flat
G	Washer M6 Spring
H	Screw M6 x 16 Hex Socket
J	RAM Standard Arm
K	Screw M8 x 25 Pan Head
L	RAM Vesa Base
M	Washer M8 Internal Tooth
N	Nut M8 x 1.25
P	Screw M8 x 25 Flat Head
Q	RAM Circular Base
R	RAM Short Arm (Not Shown)
S	Mounting Kit MT3505
T	Mounting Kit MT3507
U	Mounting Kit MT3509
V	Mounting Kit MT3510

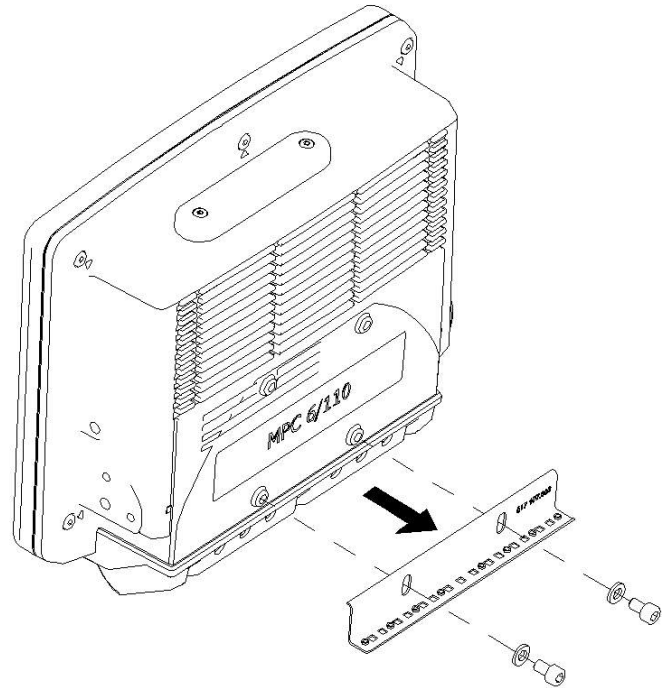

Figure 6

Step 2: Assemble RAM Base to 8580/90 VMT: For assembling the RAM Vesa Base (E) to the 8580/90 Terminal (A) see **Figure 7**.

Note: Be advised there are two choices in RAM Arm lengths. Short (4 inch) reference (R) and Standard (12 inch) reference (J). The Standard Arm (J) is shown in all RAM Mount illustrations.

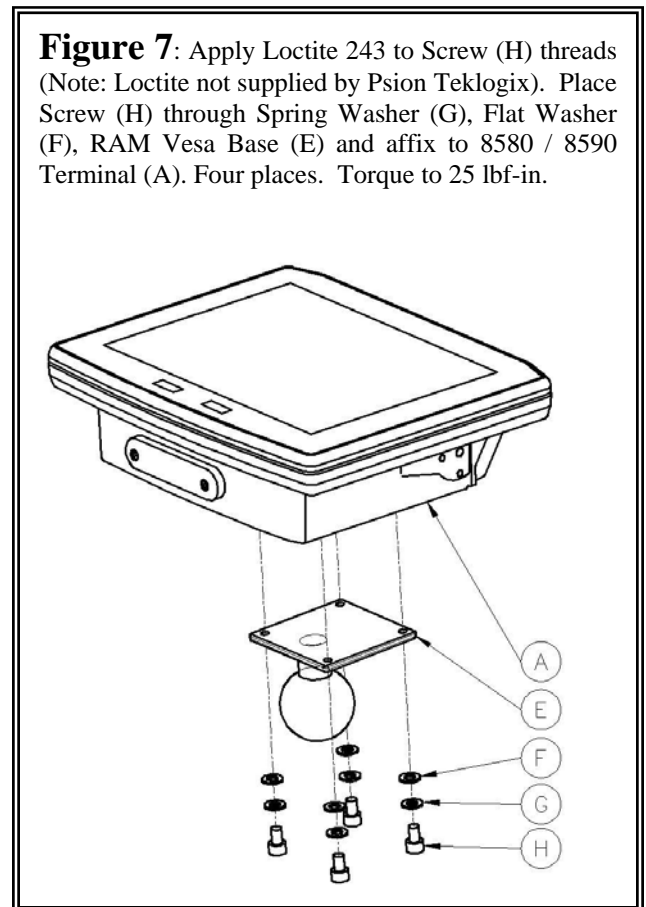
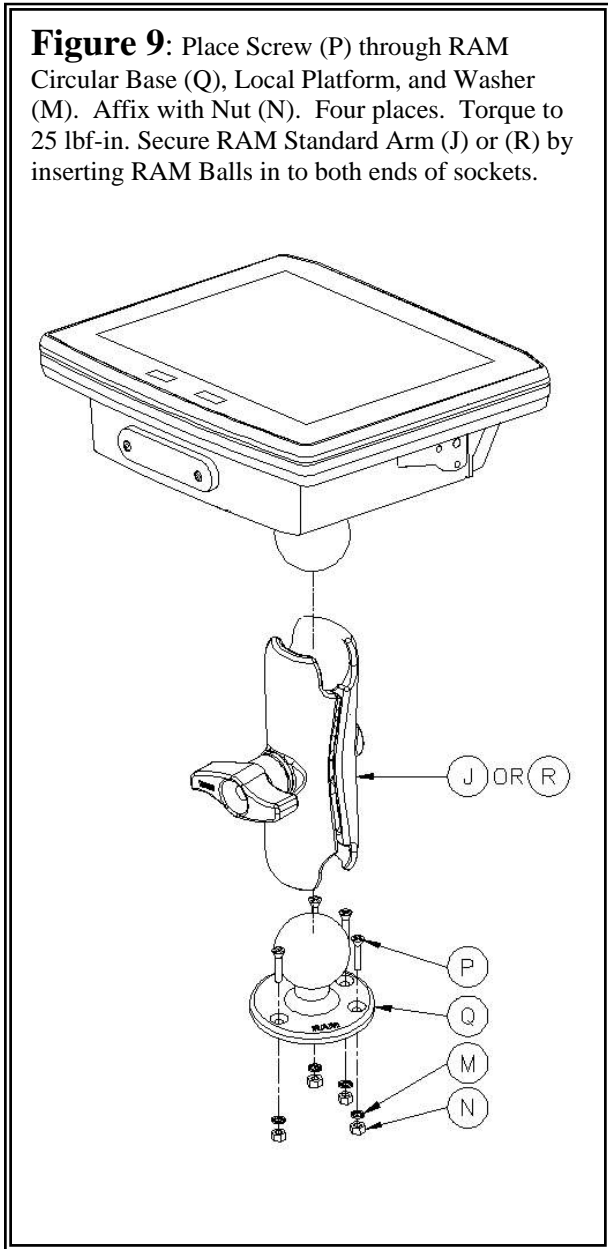
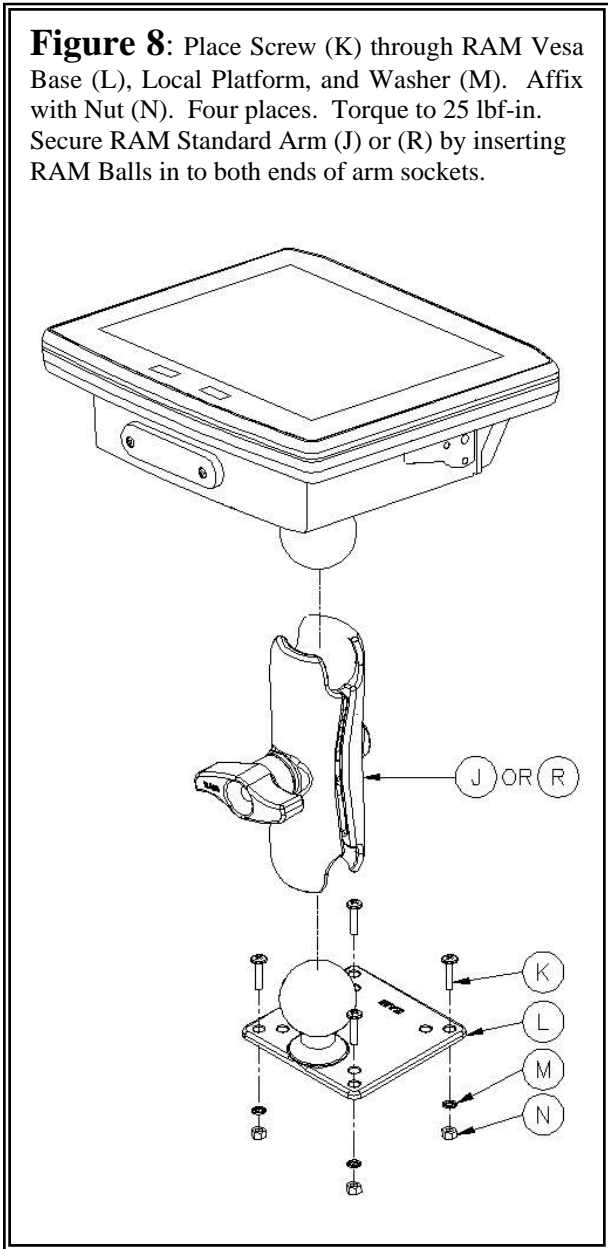

Figure 7: Apply Loctite 243 to Screw (H) threads (Note: Loctite not supplied by Psion Teklogix). Place Screw (H) through Spring Washer (G), Flat Washer (F), RAM Vesa Base (E) and affix to 8580 / 8590 Terminal (A). Four places. Torque to 25 lbf-in.

Step 2: Secure RAM Base to Local Platform and Attach RAM Standard Arm: Use the supplied bolt hole pattern to drill the required holes in the local platform. Hole diameters must not exceed 10mm [13/32 inches]. Hardware (K, M, N & P) for securing RAM Bases (L or Q) to the local platform are recommended sizes. If replacement hardware is need, it should be consistent with these diameters. All fasteners must use a suitable locking mechanism to ensure they do not loosen under shock & vibration. For assembling with RAM Vesa Base see Figure 8. For assembling with RAM Circular Base see Figure 9.



Step 3: Positioning

Mount: Place 8580/90 VMT into the position best corresponding to RAM hardware used (see figure 10) and tighten by hand until secure. Refer to first page of this document for warnings and proper tightening technique. Mount orientations shown in Figure 10 are considered the preferred configurations for the Circular Base to Platform and Vesa Base to Platform.

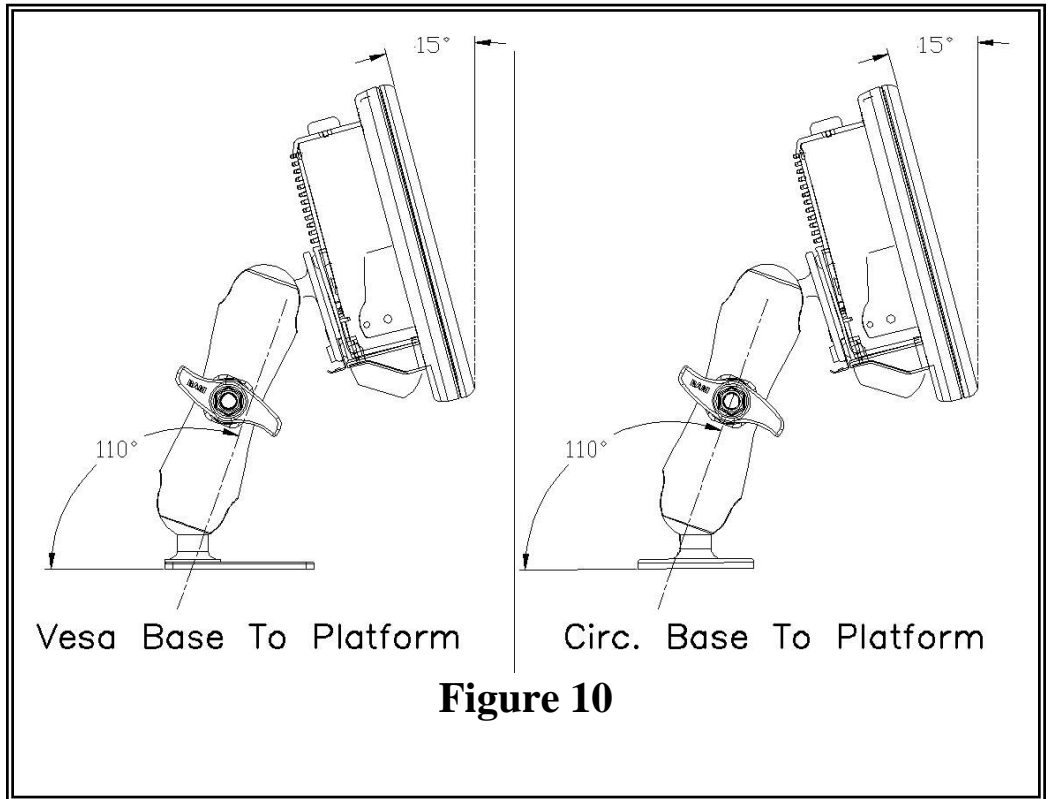

Optional Mount Kit: One of the mounting kits shown in Figure 11 may be substituted for the Vesa Base (L) or the circular base (Q) when mounting to a post or forklift roll cage.

To Install: Mount Clamp Base and Lower Base around shaft. Place Screw through Clamp and Lower Base and affix with Nut. Torque to 25 lbf-in. Secure RAM Standard Arm (J) or (R) by inserting RAM Balls in to both ends of arm sockets.

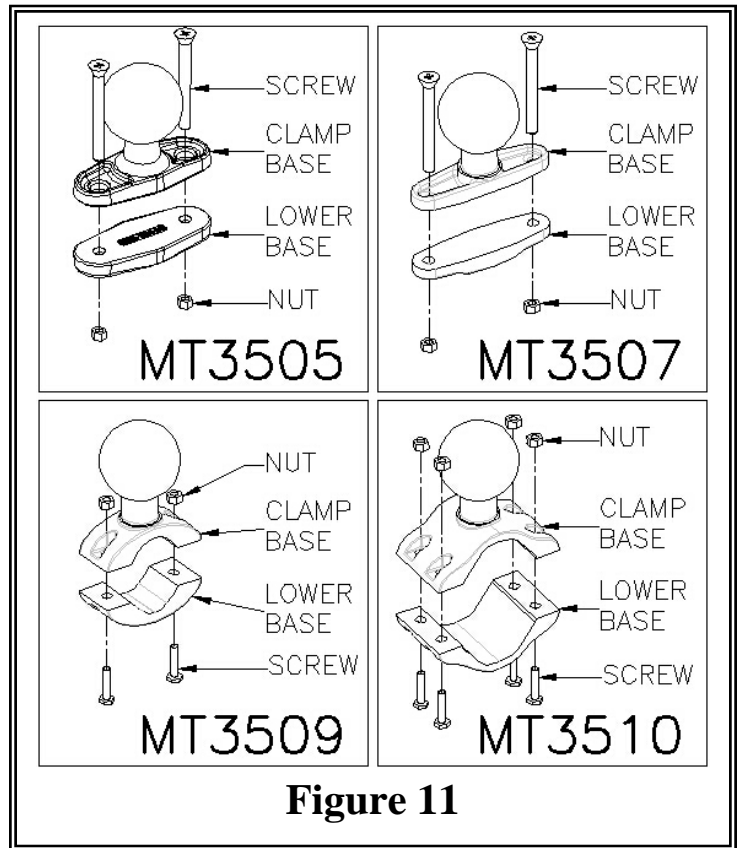

Specifications:

Max. Load: 15 kg

Articulating Range: Spherical through 180 degrees.

Shock Rating	Vibration Rating
IEC 60721-3-5 class 5M2 * Test I: 15g maximum, half-sine, 11ms duration. * Test II: 30g maximum, half-sine, 6ms duration. MIL-STD-810F, Meth. 516:5 20g maximum, saw tooth, 11ms duration.	IEC 60721-3-5 Class 5M2 (Random Vibration) 1.9g rms maximum, 5-500 Hz MIL-STD-810F, Meh. 514.6

Compatibility:

Standard Mounting Bracket	RAM Mount
MT 3601 - 10/12	MT 3501
MT 3602 - 10/12	MT 3502
MT 3604 - 10/12	MT 3505
	MT 3507
	MT 3509
	MT 3510
	MT 3601 - 10/12
	MT 3603 - 10/12
	MT 3604 - 10/12

Psion Teklogix Service Parts:

Legend Item	Description	Psion Teklogix Part Number
B	Standard Mount Bracket	9010210
C	Screw M8 x 12 Hex Socket	Kit only (MT3420)
D	Washer M8 Flat	Kit only (MT3420)
E	RAM Vesa Base (Smaller)	9010209
F	Washer M6 Spring	9010213
G	Washer M6 Flat	9010212
H	Screw M6 x 16 Hex Socket	9010211
J	RAM Standard Arm	9001805
K	Screw M8 x 25 Pan Head	9004518
L	RAM Vesa Base	9001934
M	Washer M8 Internal Tooth	9008800
N	Nut M8 x 1.25	9008801
P	Screw M8 x 25 Flat Head	9004522
Q	RAM Circular Base	9001804
R	RAM Short Arm	9001932



Appendix A: Support Services and WorldWide Offices

Support Services

Psion Teklogix provides a complete range of product support services to its customers worldwide. These services include post-installation technical support and product repairs.

Canada and USA: Technical Support and Repair Services

In Canada and the U.S.A. these services can be accessed through the Psion Teklogix Helpdesk. The Helpdesk coordinates repairs, helps you troubleshoot problems over the phone, and arranges for technicians or engineers to come to your site. Canadian and U.S. customers may receive access to technical support services, ranging from phone support to emergency on-site system support, by calling the toll-free number below, or via our secure web site.

Note: Customers calling the toll-free number should have their Psion Teklogix customer number or trouble ticket number available.

Voice: 1 800 387-8898

Fax: 1 905 812-6304

Web Site: <http://service.psionteklogix.com>

WORLD WIDE WEB

www.psionteklogix.com

International Support

For technical support outside of Canada or the U.S.A., please contact your local Psion Teklogix office.



Psion Teklogix Worldwide Offices and *Service Centers

North America

Canada (corporate office)

*Psion Teklogix Inc.
2100 Meadowvale Blvd.
Mississauga, Ontario L5N 7J9
Canada
Tel: +1 905 813 9900
americas.marketing@psionteklogix.com

Psion Teklogix Inc.
Integration Services Group
Suite 410-13251 Delf Place
Richmond, BC.V6V 2A2
Canada
Tel: 1 604 214 7400
americas.marketing@psionteklogix.com

Psion Teklogix Systems
3026 Solandt Road
Kanata, Ontario K2K 2A5
Canada
Tel: 613-592-2592
Fax: 613-592-6778

U.S.A.

*Psion Teklogix Corp.
1810 Airport Exchange Blvd
Suite 500 Erlanger
Kentucky 41018
United States
Tel: +1 859 371 6006
americas.marketing@psionteklogix.com

Mexico

Psion Teklogix S.A. de C.V.
Sierra Mojada 626-2
Col. Lomas Barrilaco
D.F. 11010
Mexico
Tel: +5255 5202 6802
americas.marketing@psionteklogix.com

Europe

Belgium

Psion Teklogix Benelux
Nieuwe Weg 1
2070 Zwijndrecht
Belgium
Tel: +32 3 250 22 00
info@psionteklogix.be

Denmark

Psion Teklogix AB (Denmark)
Branch of Psion Teklogix A.B.
Vesterballevej 4-6
DK-7000 Fredericia
Denmark
Tel: +4576240133
info@psionteklogix.dk

France

*Psion Teklogix S.A. [Aix En Provence]
Parc de la Duranne
135, rue René Descartes
BP 421 000
13591 Aix En Provence
Cedex 3
France
Tel: +33 4 42908809
contact@psionteklogix.fr

Germany

Psion Teklogix Gmbh
Jakob-Kaiser-Str. 3
47877 Willich Münchheide
Germany
Tel: +49 2154 92820
info@psionteklogix.de

Italy

Psion Teklogix Srl
Piazza Don Mapelli 75
20099 Sesto S. Giovanni (MI)
ITALY
Tel + 39 02 2412471
Fax + 39 02 24124701
Email: tkxitalia@psionteklogix.com

Spain

Psion Teklogix S.L. Espana
WTC Almeda Park-Poligono
Almeda
Placa de la Pau s/n
Edificio no 3, 2 Planta
08940 Cornellà de Llobregat
Barcelona
Spain
Tel: +34 93 475 0220
teklogix@psionteklogix.com

Sweden

Psion Teklogix AB
Stora Badhusgatan 18-20
11 21 Gothenburg
Sweden
Tel: +46 31 339 3090
info@psionteklogix.se

Switzerland

1A Chemin de la Dent D Oche
Ecublens, VD 1024
Switzerland
Tel: +41 21 694 8010
christophe.francois@psionteklogix.com

United Kingdom

Psion Teklogix (UK) Limited
Bourne End Business Centre
Cores End Road
Bourne End
Buckinghamshire SL8 5AR
United Kingdom
Tel: +44 1628 648800
enquiries@psionteklogix.com

Asia

China

Psion Teklogix (Shanghai)
Wireless Technologies Co., Ltd.
Unit 1507-08
Mingshen Building
No.3131 Kai Xuan Rd
Shanghai 200030
China
Tel: +86 21 5407 1991
ptchina@psionteklogix.com

India

Psion Teklogix Systems India Pvt. Ltd.
V-11, 2nd Floor, Green Park Extn
New Delhi-India, 110016,
phone: +91-11-5107 4500/ 5107
6500 /5107 8500/ 5107 9500
Fax : +91-11-5107 0500
tekind@psionteklogix.com

Japan

Psion Teklogix Japan
Ark Mori Building 12F
1-12-32, Akasaka, Minato-ku,
Tokyo 107-6012
Tel: 813 4360-8272
Fax: 813 4360-8201
Email: kazuo.aoki@psionteklogix.com

Singapore

Psion Teklogix Asia Pacific Pte Ltd
152 Beach Road
#22-03/04 Gateway East
Singapore 189721
Tel: +65 6296 2232
Fax: +65 6296 2322
teksing@psionteklogix.com

Korea

Psion Teklogix Korea
904 Cresyn Tower
8-24 Jamwon-dong
Seocho-kn, Seoul
Korea
Tel: +822 344 51256
Calvin.cho@psionteklogix.com

Middle East

Dubai

Psion Teklogix Dubai
P.O. Box 261659 JAFZ
Sheikh Zayed
Emaar Building #2, Unit 615
Dubai
UAE
Tel: +971 4 368 9412
Joe.iarocci@psionteklogix.com

Israel

Psion Teklogix Israel
14 Ze'elon St. Unit 47
Or-Yehuda
Israel 60407
Tel: +972 3 634 8001
quv.perry@psionteklogix.com

Africa

South Africa
Psion Teklogix South Africa
Proprietary Limited
Grd Flr East, Waterfall Edge
Phase 2, Waterfall Park
Bekker Rd.
Midrand 1685
South Africa
Tel: +2711 8057440
sales@psionteklogix.co.za
8/05

* Authorized Service Center

Bolt Hole Pattern For
Standard Mounting Bracket:

EDGE OF
MOUNTING
BASE

1.575
[40MM]

7.874
[200MM]

Ø 0.354
[Ø 9MM]
10 PLACES

Ø 0.256
[Ø 6MM]
4 PLACES

FRONT OF
MOUNT

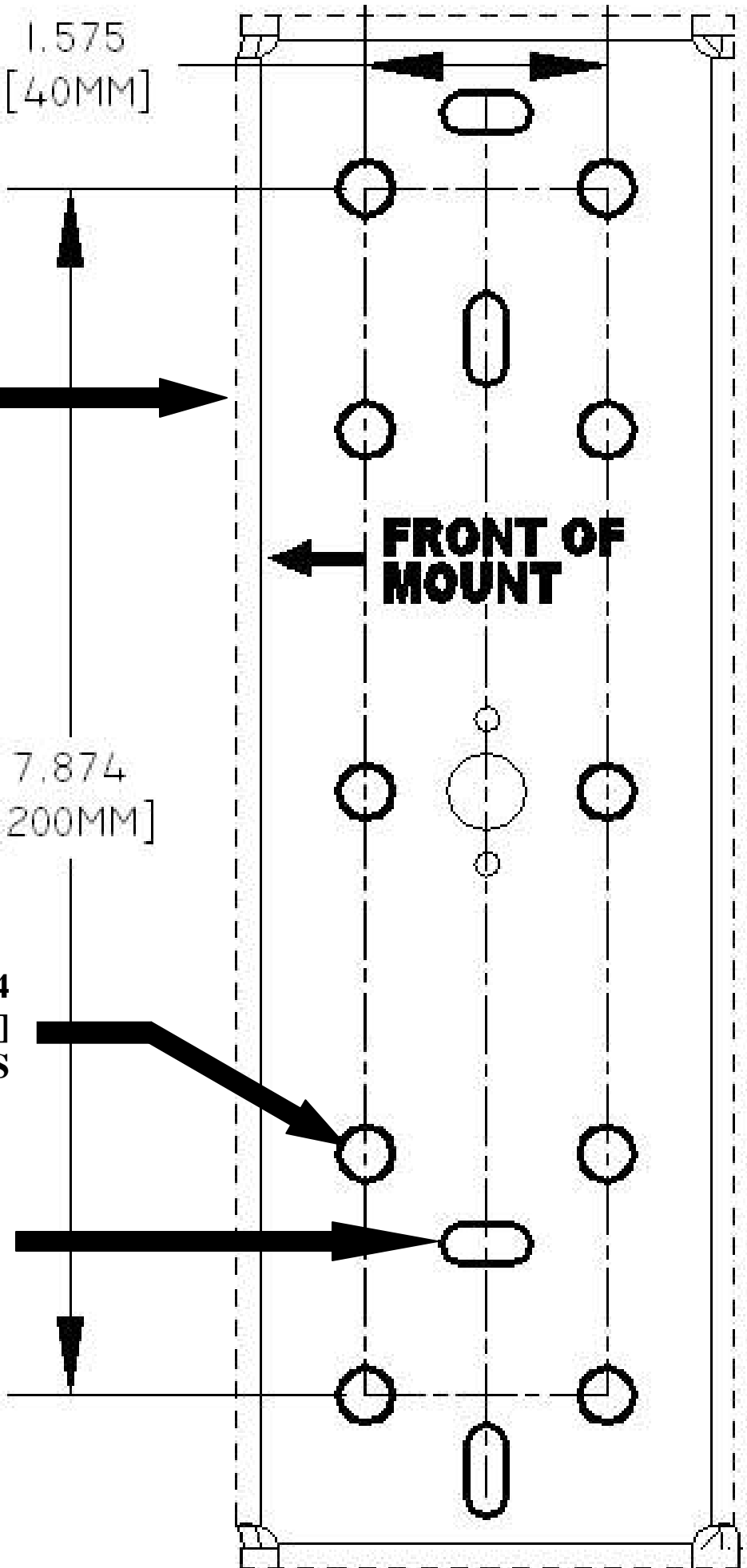

Bolt Hole Pattern For RAM Circular Base:

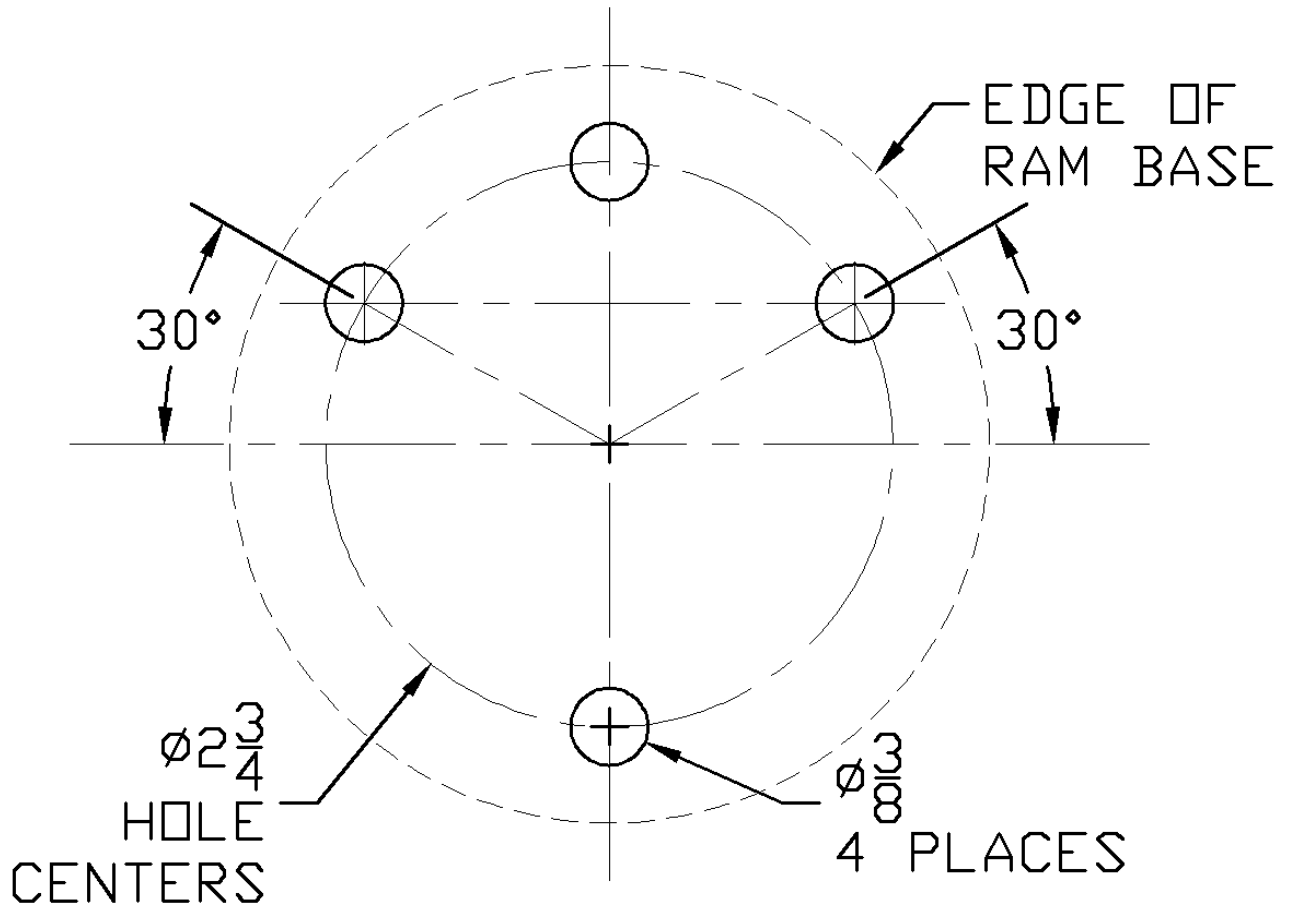

Bolt Hole Pattern for RAM Vesa Base:

